

Scan the QR code to view or download digital versions of the product documents.

<b>Ambient operating temperature</b>	0 °C to +40 °C
<b>Electrical power rating</b>	100-240 V~, 50/60 Hz, 1A, 12W max
<b>Power supply unit</b>	This Class II product, VIP7300, shall be powered by the Limited Power Supply that is provided together with the product.

The following table shows the maximum EU RF Output Power:

Frequency Band (GHz)	Maximum RF Power (dBm)
2.4 to 2.48	10
5.150 – 5.350*	23
5.470 – 5.725	23

\*Indoor use only BE, BG, CZ, DK, DE, EE, IE, EL, ES, FR, HR, IT, CY, LV, LT, LU, HU, MT, NL, AT, PL, PT, RO, SI, SK, FI, SE, and UK(NI).

Typical Product Energy Consumption (W)	
Network Standby	1.84
On Mode	3.53

Deactivating the wireless function: This equipment relies on wireless function (e.g. Wi-Fi) for its normal operation. If you have the equipment connected via Ethernet, you can disable the wireless network and still use the equipment's main functions. You can use the device's user interface to disable the wireless function. Please note that the Bluetooth wireless function is needed for some important functions in the equipment.

Hereby, Vantiva Technologies declares that the radio equipment type VIP7300 is compliant with Radio Equipment Directive 2014/53/EU, Energy related Products Directive 2009/125/EC and RoHS Directive 2011/65/EU. The latest version of EU declaration of conformity is available at the following internet address: [www.vantiva.com/regulatory-information](http://www.vantiva.com/regulatory-information)

Energy efficiency information for the product and the power supply provided with it can be found at the following address: [www.vantiva.com/regulatory-information](http://www.vantiva.com/regulatory-information)

EU Compliance is maintained at the following address:

Vantiva Technologies, 10 boulevard de Grenelle, 75015 Paris, France



**Caring for the Environment by Recycling**

Electrical and electronic equipment that has run out of service life must be handed over to municipal collection centres or may be delivered to the dealer when purchasing new equipment.

Please recycle product packaging and this document.



5509111B



VIP7300  
Set-top box  
Installation Guide

## INSTALLING YOUR SET-TOP BOX

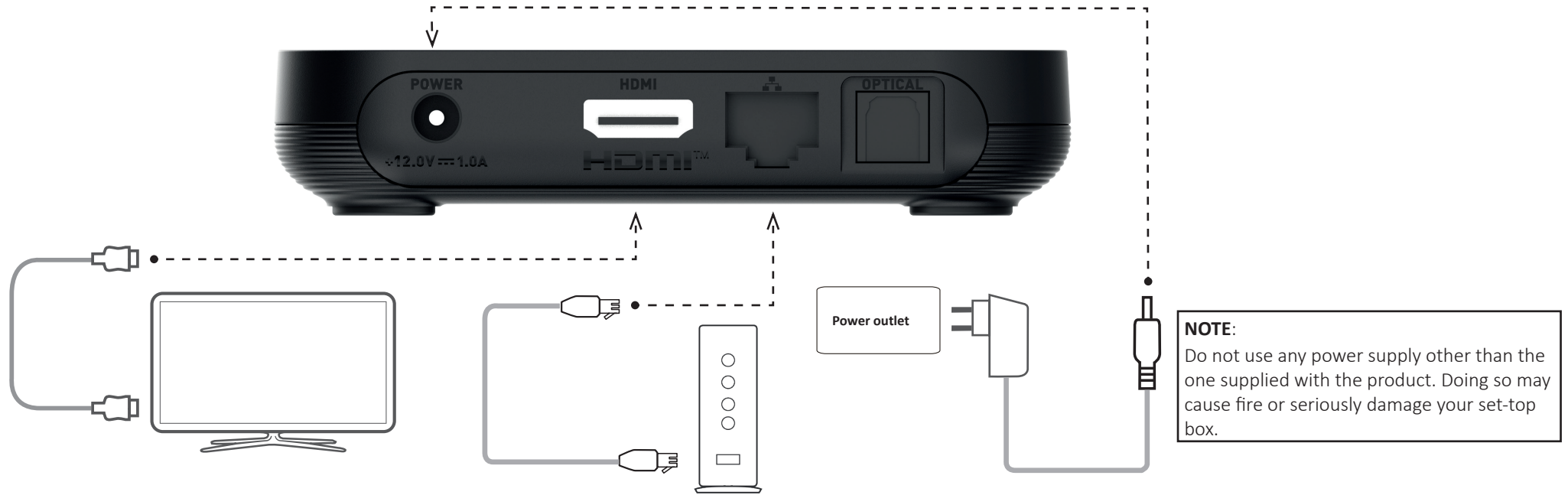

1

Connect one end of the HDMI cable to the **HDMI** port on your set-top box and the other end to the HDMI connector on your TV.  
To display a picture from your set-top box, your TV must be switched to the correct external input. This is either done automatically or manually, using a button on the TV remote control. See your TV user's guide for instructions.

2

Connect your set-top box to your home Wi-Fi network.  
**Alternatively:** Connect one end of the Ethernet cable (not included) to the Ethernet port on your set-top box and the other end to your home router.  
**NOTE:**When removing the Ethernet/LAN cable make sure to firmly press the underside latching tab on the Ethernet/LAN cable; to unlock the cable from the Ethernet/LAN port on the product.

3

Connect one end of the power supply to **POWER** port on your set-top box and to the power outlet.

4

Insert the batteries into your remote control.  
The remote control will initiate pairing with your set-top box when batteries are inserted and any key is pressed.

### Product safety

The General Product Safety Regulation (GPSR) was established in response to the challenges and emerging risks associated with new technologies. It aims to protect consumers while promoting trust and transparency. We are committed to ensuring that you have the information you need to use our products responsibly and with confidence. Nevertheless, if you have any questions, concerns or comments regarding the safety of our products, please do not hesitate to contact us at [gpsr@vantiva.com](mailto:gpsr@vantiva.com), our customer support team will be delighted to assist you.

The terms HDMI, HDMI High-Definition Multimedia Interface, and the HDMI Logo are trademarks or registered trademarks of HDMI Licensing Administrator, Inc. Manufactured under license from Dolby Laboratories. Dolby, Dolby Audio, and the double-D symbol are trademarks of Dolby Laboratories Licensing Corporation.  
© 2025 Vantiva SA. All rights reserved. Vantiva and the Vantiva logo are registered trademarks of Vantiva SA. ARRIS and the ARRIS logo are registered trademarks of CommScope and are used under license by Vantiva SA. All other company and product names mentioned are trademarks of their respective owners.